



PLASMA

DWP Plasma cutting torches	p. 196
DWP-90 Plasma cutting torch	p. 198
DWP-90M Plasma cutting torch	p. 199
DWP-150 Plasma cutting torch	p. 200
Plasma parts suitable for SAF	p. 201
Plasma parts suitable for CEBORA	p. 202
Plasma parts suitable for TRAFIMET	p. 204



PLASMA CUTTING TORCHES

THE CONCEPT

A own line of plasma cutting torches has been developed. In addition, spare parts for a number of other brands are available at Translas.



OWN DWP PLASMA TORCH

The DWP line of torches is an exclusive Translas brand of plasma torches with a unique plasma head and additional features. They are available in 2 types: 90 and 150 amperes.



PLASMA CUTTING

Plasma cutting is a process that is used to cut steel and other metals of various thicknesses using a plasma torch.

In this process, an inert gas (or compressed air) is blown at high speed out of the nozzle; at the same time an electrical arc is formed through the gas from the nozzle to the surface being cut, turning part of the gas to plasma.

The plasma is hot enough to melt the metal being cut and moves fast enough to blow the molten metal away from the cut.

- A** Re-inforced hoses for the waterhose.
- B** Flex hoses for the powercable.
- C** Fuel hoses for the heavy duty powercables.
- D** Proflex hoses if high flexibility is required.





STRONG HANDLE

A strong banana-shaped handle is required for plasma torches.

SUSPENSION HOOK

An additional suspension hook has been mounted on the DWP handle.

THE ADVANTAGE

Our exclusive DWP plasma torch has its unique range of additional features and spare parts. Therefore we always create the ideal cutting surface.

BLADE SWITCH

We have chosen for a heavy duty blade switch for the plasma torch handle.



SPARE PARTS OTHER BRANDS

We have a wide range of spare parts available for several other brands.



DWP-90 PLASMA TORCH



100% DUTY CYCLE AT 90 AMP

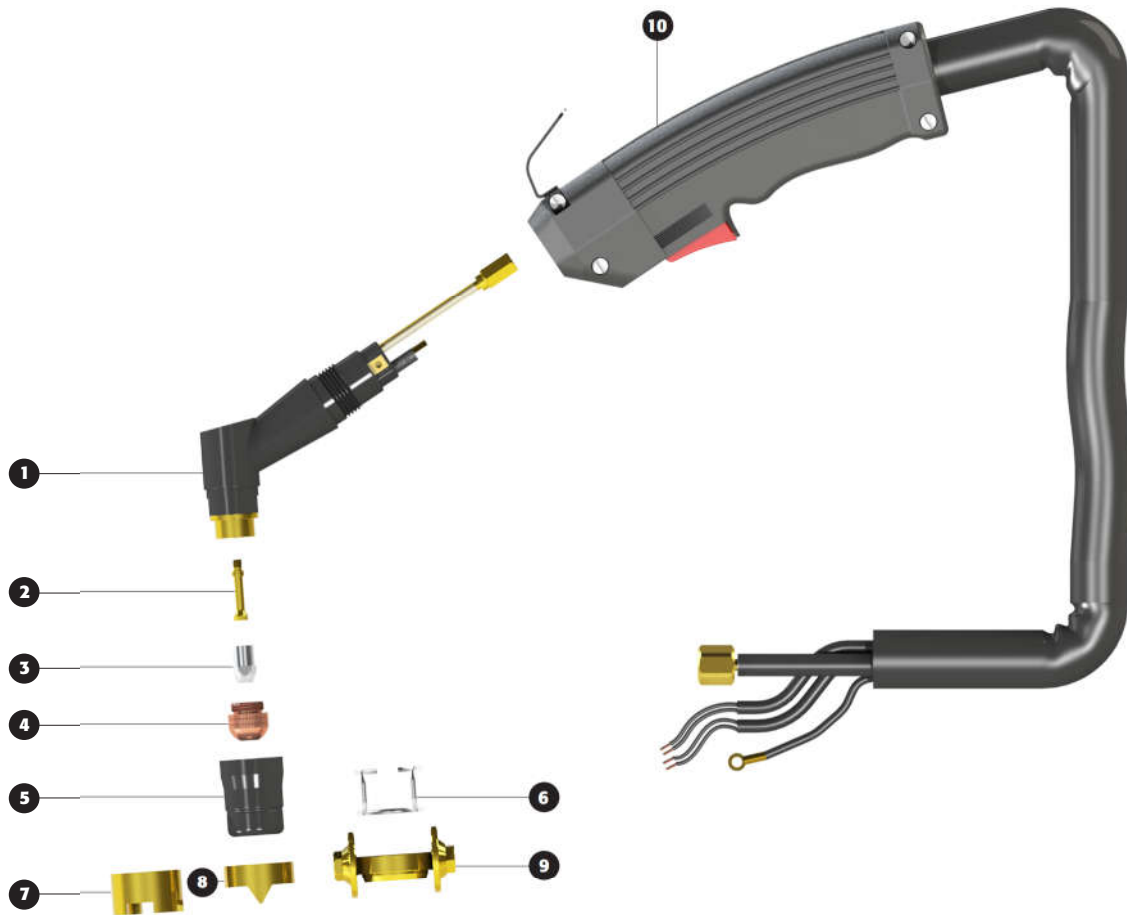

ITEM	PART NUMBER	DESCRIPTION	PACK QTY
-	9010200	90 Amp Plasma torch with M14x1 connection 6mtr	1
-	9010500	90 Amp Plasma torch with M14x1 connection 12mtr	1
1	453000	TR0656 Torch head	1
2	453600	TR0749 Air regulator tube	3
3	453410	TR0189 Hafnium electrode	10
4	453210	TR0702 Cutting tip 1,0mm	10
	453230	TR0703 Cutting tip 1,2mm	10
	453240	TR0704 Cutting tip 1,4mm	10
	453250	TR0705 Cutting tip 1,7mm	10
	453260	TR0764 Cutting tip 2,0mm	10
5	453510	TR0413 Plastic nozzle	10
6	454000	TR0618 Spacer ring	10
7	454005	TR66001 Crown spacer 4-point	2
8	454010	TR66002 Crown spacer 2-point	2
9	454040	TR88000 Cutting guide	1
10	453710	TR0399 Handle	1



DWP-90M MACHINE PLASMA TORCH



100% DUTY CYCLE AT 100 AMP

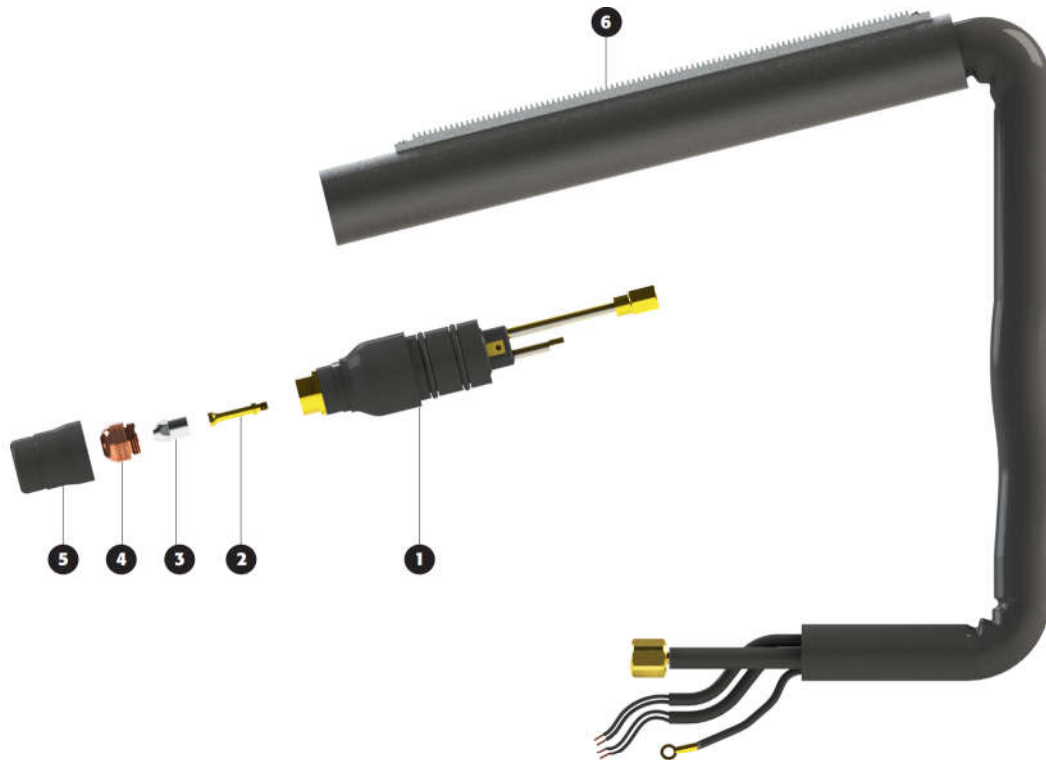

ITEM	PART NUMBER	DESCRIPTION	PACK QTY
-	9211200	90 Amp Machine plasma torch with M14x1 connection 6mtr	1
-	9211500	90 Amp Machine plasma torch with M14x1 connection 12mtr	1
1	453020	TR0296 Torch head	1
2	453600	TR0749 Air regulator tube	3
3	453410	TR0189 Hafnium electrode	10
4	453210	TR0702 Cutting tip 1,0mm	10
	453230	TR0703 Cutting tip 1,2mm	10
	453240	TR0704 Cutting tip 1,4mm	10
	453250	TR0705 Cutting tip 1,7mm	10
	453260	TR0764 Cutting tip 2,0mm	10
5	453510	TR0413 Plastic nozzle	10
6	453720	TR0231 Handle with rack	1



DWP-150 PLASMA TORCH



100% DUTY CYCLE AT 150 AMP

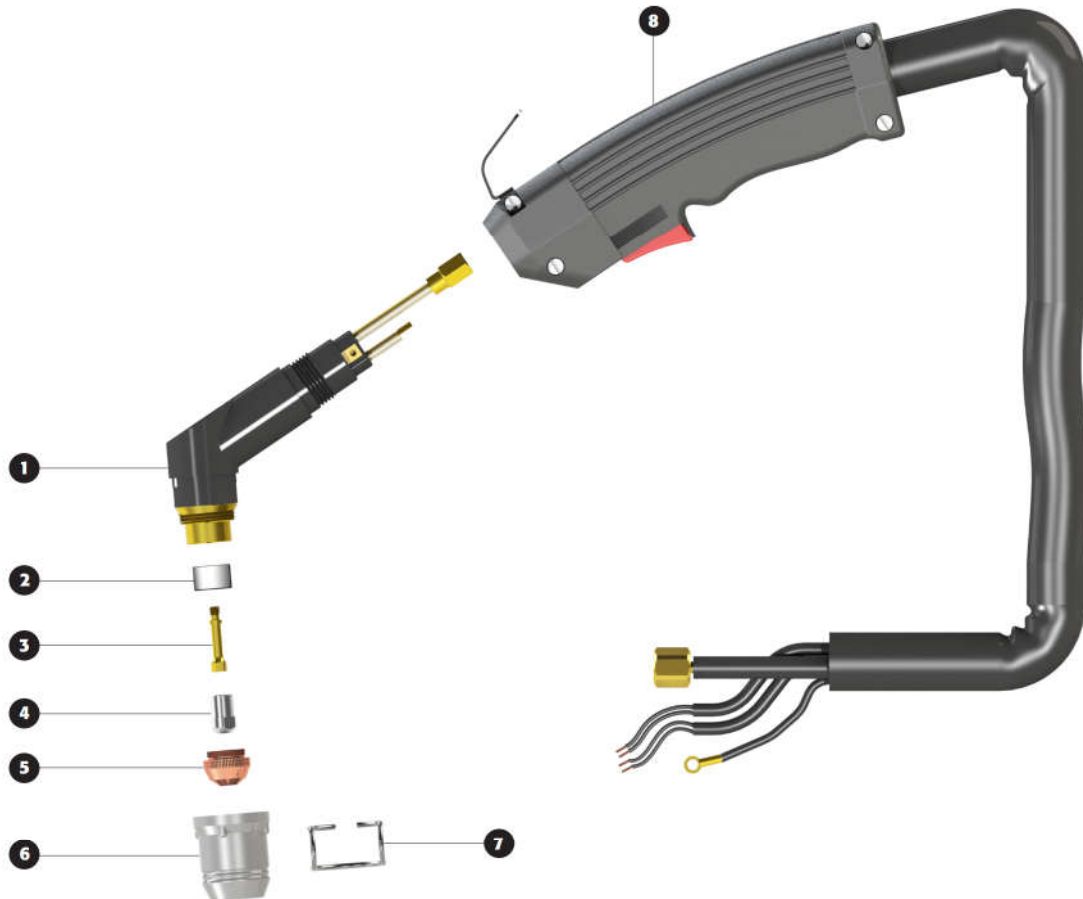

ITEM	PART NUMBER	DESCRIPTION	PACK QTY
-	9012200	150 Amp Plasma torch with M14x1 connection 6mtr	1
-	9012500	150 Amp Plasma torch with M14x1 connection 12mtr	1
1	453070	TR0655 Torch head	1
2	453620	TR1393 Insulator	3
3	453602	TR1462 Air regulator tube	3
4	453412	TR0892 Hafnium electrode	10
5	453338	TR1464 Cutting tip 1,0mm	10
	453340	TR1465 Cutting tip 1,2mm	10
	453342	TR1466 Cutting tip 1,4mm	10
	453344	TR1467 Cutting tip 1,7mm	10
	453346	TR1468 Cutting tip 2,0mm	10
6	453512	TR0817 Plastic nozzle	10
7	454002	TR1459 Spacer ring	10
8	453710	TR0399 Handle	1



PLASMA PARTS SUITABLE FOR SAF



ITEM	PART NUMBER	DESCRIPTION	PACK QTY
1	457000	0408-2051 Zirconium electrode	10
	457005	0408-2404 Hafnium electrode	10
2	457020	0408-2261 Cutting tip 1,0mm	10
	457030	0408-2262 Cutting tip 1,2mm	10
	457032	0408-2385 Cutting tip 1,6mm	10
3	457035	0408-2267 Plastic nozzle	2
	457075	0408-2405 Nozzle	2
4	454000	0408-2053 Spacer ring	10

NOTE: Other SAF spare parts can be supplied on request.



PLASMA PARTS SUITABLE FOR CEBORA

PROF 35/50

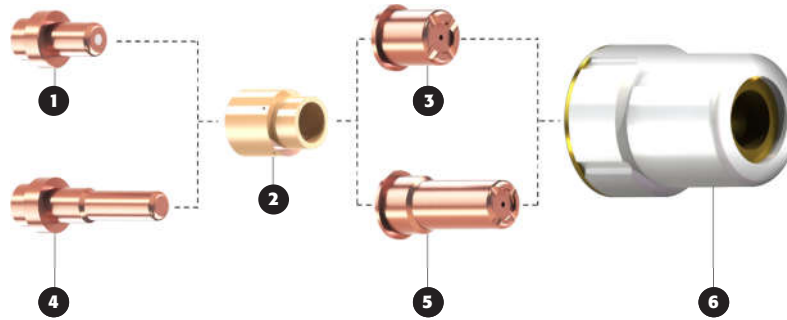

ITEM	PART NUMBER	DESCRIPTION	PACK QTY
1	455500	1521 Electrode	10
2	455420	1510 Swirl ring	5
3	455430	1304 Cutting tip 1,0mm	10
4	455510	1518 Long electrode	10
5	455540	1370 Long cutting tip 1,0mm	10
6	455550	5710121 Nozzle	2

PROF 52/70

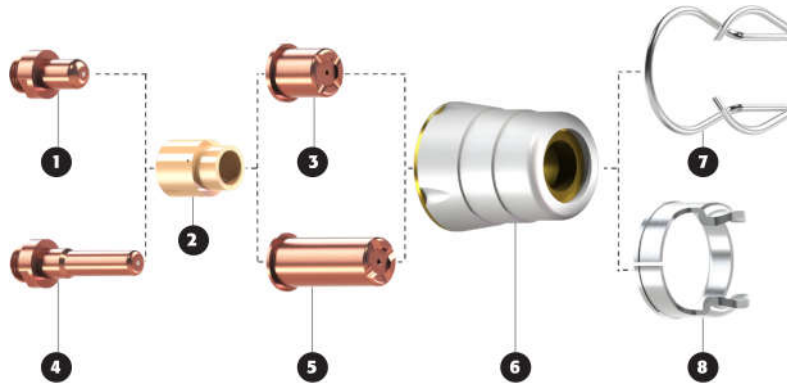

ITEM	PART NUMBER	DESCRIPTION	PACK QTY
1	455590	1402 Electrode	10
2	455420	1510 Swirl ring	5
3	455581	1396 Cutting tip 1,0mm	10
	455582	1308 Cutting tip 1,2mm	10
4	455591	1403 Long electrode	10
5	455586	1395 Long cutting tip 1,0mm	10
6	455595	5710171 Nozzle	2
7	455560	1394 Spacer ring	10
8	455597	1405 Crown spacer	2

PROF 90/120/150

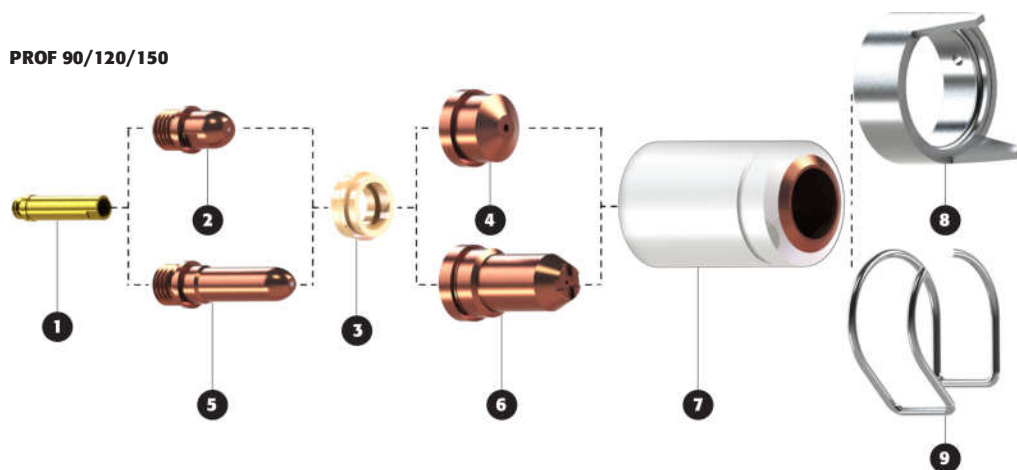

ITEM	PART NUMBER	DESCRIPTION	PACK QTY
1	455615	1378 Diffuser	5
2	455627	1376 Electrode	10
3	455630	1377 Swirl ring	5
4	455640	1371 Cutting tip 1,1mm	10
	455642	1372 Cutting tip 1,35mm	10
	455644	1373 Cutting tip 1,6mm	10
	455646	1374 Cutting tip 1,8mm	10
5	455620	1517 Long electrode	10
6	455650	1369 Long cutting tip	10
7	455660	1389 Nozzle	2
8	455670	1408 Crown spacer	2
9	455655	1386 Spacer ring	10

NOTE: Other Cebora spare parts can be supplied on request.



PLASMA PARTS SUITABLE FOR TRAFIMET

S30/S54

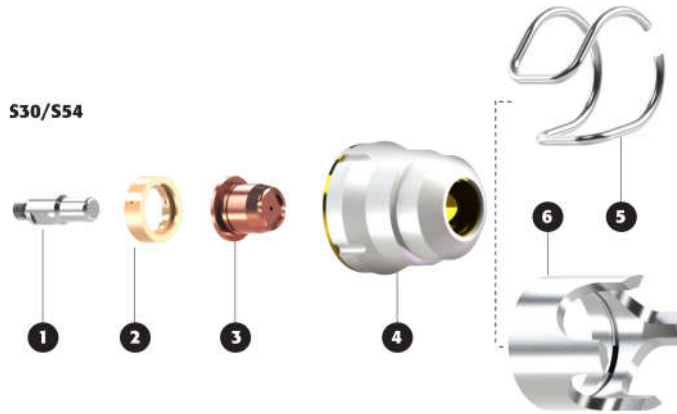

ITEM	PART NUMBER	DESCRIPTION	PACK QTY
1	460212	PR110 Electrode	10
	460210	PR105 Electrode	10
	460211	PR106 Long electrode	10
2	460205	PE106 Swirl ring	5
3	460219	PD116-08 Cutting tip 0,8mm	10
	460218	PD103-09 Long cutting tip 0,9mm	10
	460200	PD102-10 Cutting tip 1,0mm	10
4	460231	PC116 Nozzle	2
	460230	PC115 Nozzle	2
5	460233	CV10 Spacer ring	10
	460250	CV28 Spacer ring	10
6	460240	CV33 Crown spacer	2

A80

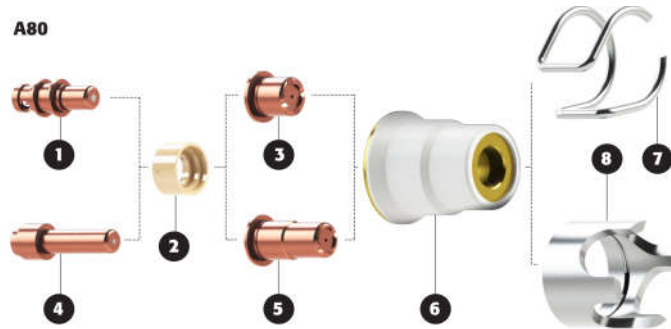

ITEM	PART NUMBER	DESCRIPTION	PACK QTY
1	460300	PR107 Electrode	10
2	460320	PE107 Swirl ring	5
3	460220	PD105-10 Cutting tip 1,0mm	10
4	460310	PR108 Long electrode	10
5	460335	PD106-10 Long cutting tip 1,0mm	10
	460336	PD106-12 Long cutting tip 1,2mm	10
6	460230	PC115 Nozzle	2
7	460250	CV28 Spacer ring	10
8	460240	CV33 Crown spacer	2

A 90/A 140

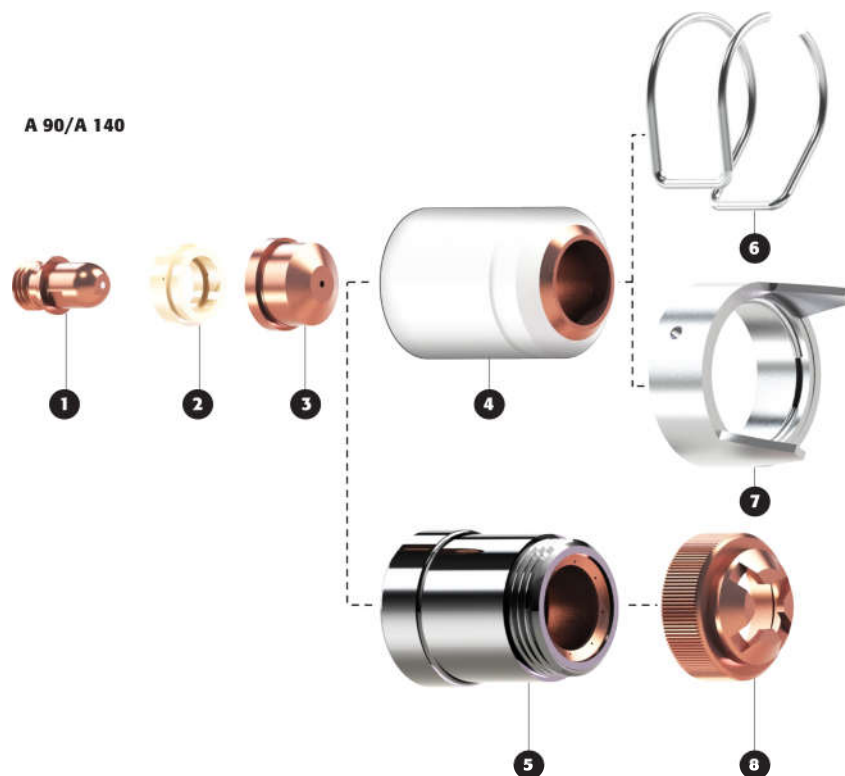

ITEM	PART NUMBER	DESCRIPTION	PACK QTY
1	460500	PR101 Electrode	10
2	460510	PE101 Swirl ring	5
3	460520	PD101-11 Cutting tip 1,1mm	10
	460521	PD101-14 Cutting tip 1,4mm	10
	460522	PD101-17 Cutting tip 1,7mm	10
	460523	PD101-19 Cutting tip 1,9mm	10
4	460530	PC109 Nozzle	2
	460535	PC101 Nozzle	2
5	460580	PC113 Contact nozzle cap	2
	460585	PC103 Contact nozzle cap	2
6	455655	CV11 Spacer ring	10
7	455670	CV12 Crown spacer	2
8	460590	CV23 Contact spacer	2

NOTE: Other Trafimet spare parts can be supplied on request.